

Courses & distances round
the whole tract Beginning
at a post on the bank
of the Creek thence
along land of
Alex^r Stewart part
of the same tract

N 23 1/2 W 121.5 P^s
S 88 3/4 W 83.8
S 66° W 13.
N 51° W 9
S 89° W 6
N 2 E 21
N 87 W 20.8
N 1 E 23.7
S 89 1/4 W 39
thence down the Creek

N 6 3/4 W 14
N 11 E 16
N 15 E 38
N 29 1/4 E 17
N 14 1/4 E 19
N 21 W 16
N 3 E 10
N 61 E 21
S 56 E 44
S 19 E 13
S 37 W 20.5
S 53 E 12
N 58 1/2 E 23
N 84 1/2 E 38
N 47 1/2 E 17.5

distance 319 P^s
thence along land of
Snyders, Coopers. &
Tetwilers heirs to the
place of beginning.
S 32 1/2 E 297
S 86 W 30
S 60 W 39.6 Walnut
N 43 1/4 W 12
N 68 W 19 to the
place of beginning.

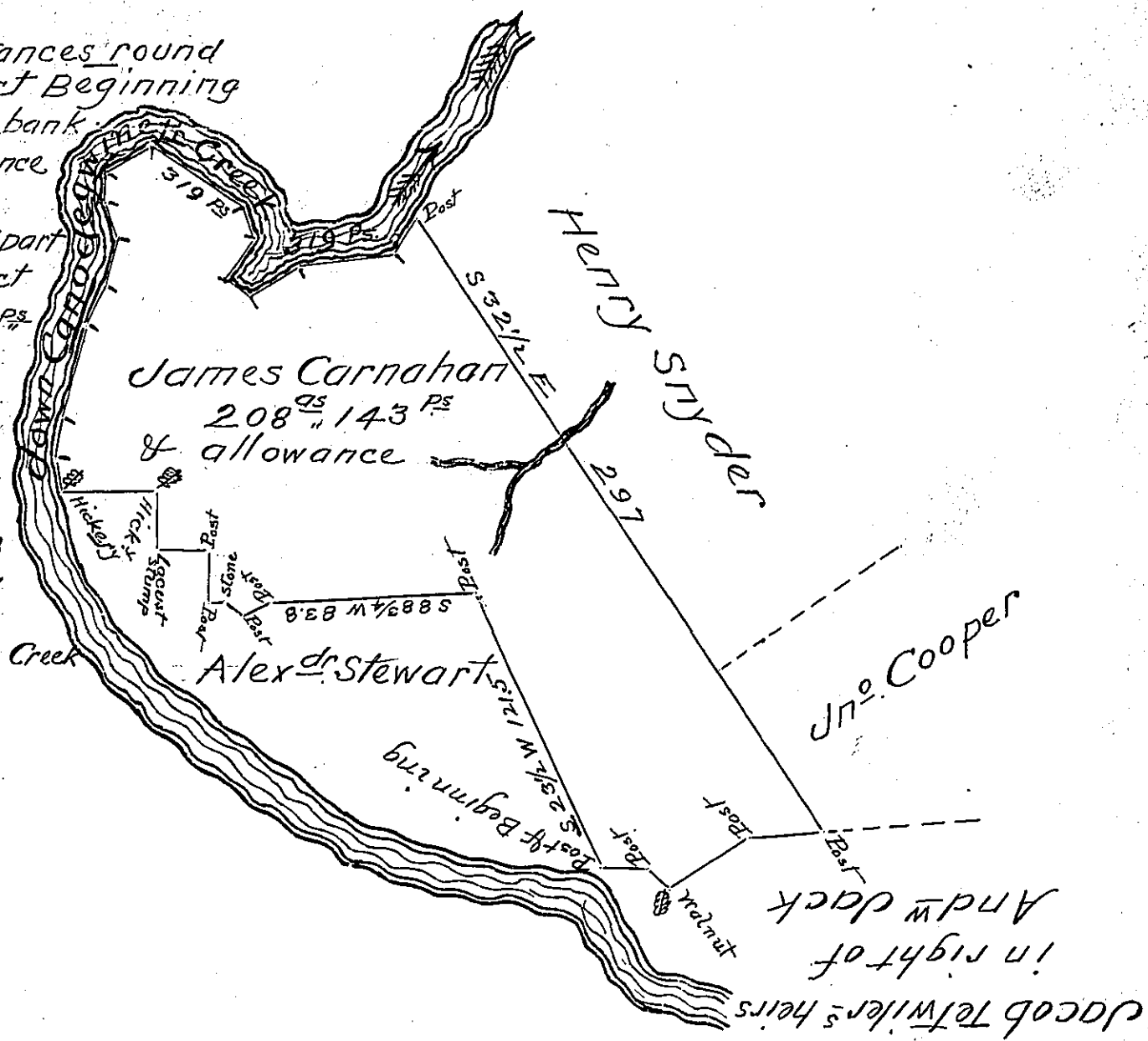

1763 Surveyed & divided May 8th Anno Domini 1822

To Samuel Cochran Esquire Sam^l Ruby Ds.
Surveyor General

Draught of a tract of land
situate in Newton Township Cum-
berland County Containing 208
Acres & 143 P^s of allowance of six P^{ct}
Cent for Roads &c. It being part of
291 acres and 146 P^s of allowance.

Surveyed In pursuance of a War-
rant granted to James Car-
nahan dat^d June 7th A Dom.

IN TESTIMONY that the above is a copy of the original remaining on file in
the Department of Internal Affairs of Pennsylvania, made
conformably to an Act of Assembly approved the 16th day of
February, 1833, I have hereunto set my Hand and caused
the Seal of said Department to be affixed at Harrisburg,
this sixteenth day of May 1904.

Joseph P. Brown
Secretary of Internal Affairs.